

## LLAS7 Photo Controls

### LLAS7-4

#### Thermal photo control

- ⊙ Rated voltage: 120V/220V~(applicable 110V,127V,230V,240V)
- ⊙ Rated frequency: 50/60Hz
- ⊙ Rated current: 10A 15A
- ⊙ Load: 1000W,2000W TUNGSTEN
- ⊙ Light level: on/off; 10-16LUX/50-80LUX
- ⊙ Acting time: 30" ~180"
- ⊙ Temperature range: -40℃~+70℃
- ⊙ Electrical life: >6500CYCLES

#### Electromagnetic photo control

- ⊙ Rated voltage: 120/240V~(applicable 105-240V~)
- ⊙ Rated frequency: 50/60Hz
- ⊙ Rated current: 10A 15A
- ⊙ Load: 1000W,2000W TUNGSTEN
- ⊙ Light level: ON/OFF;10-16LUX/20-30LUX or at customers'option
- ⊙ Acting time: <15"
- ⊙ Temperature range: -40℃~+70℃
- ⊙ Electrical life: >6500CYCLES

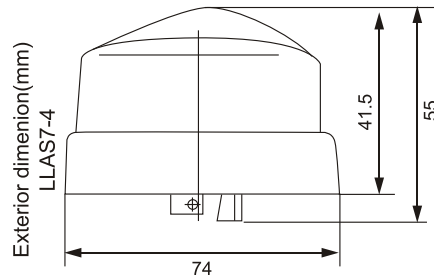

LLAS7-4

## LLAS7 Photo Controls Receptacle



LLAS7-F-1

Rated voltage: 105~480V~  
Rated current: 10A,15A  
Receptacle circumrotation: 360°



LLAS7-F-2

Rated voltage: 105~480V~  
Rated current: 10A,15A  
Receptacle circumrotation: 90° ,180°



LLAS7-F-3

Rated voltage: 105~480V~  
Rated current: 10A,15A  
Receptacle circumrotation: 360°



LLAS7-F-4

Rated voltage: 105~250V~  
Rated current: 10A,15A  
Receptacle circumrotation: 360°



LLAS7-F-5

Rated voltage: 105~250V~  
Rated current: 10A,15A  
Receptacle circumrotation: 90° ,180°



LLAS7-F-6

Rated voltage: 105~250V~  
Rated current: 10A,15A  
Receptacle circumrotation: 90° ,180°